





INVENTAR IMOBILE COMPONENTE

NC	S. Acte (mp)	S. masurata (mp)	S. extravilan (mp)	S. intravilan (mp)	Categorie de folosinta
55793	15900	15751	12453	3298	Arabil
55794	80000	80000	80000	0	Arabil/Drum/Ne productiv
59284	117000	117000	116386	614	Arabil/Drum/Ne productiv
59285	198074	198074	198074	0	Arabil/Drum/Ne productiv
60329	32070	32070	32070	0	Arabil/Ne productiv
60332	56105	56105	56105	0	Arabil/Ne productiv
S. Total (mp)	499149	499000	495088	3912	

Situl arheologic de la Izvoare - La Izvoare
Cod RAN 120815.01. cod LMI 2004 NT-I-s-B-10514
Așezarea din epoca migrațiilor de la Izvoare
Cod RAN 120815.02

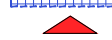
-  Imobile ce compun amplasamentul investitiei
-  Perimetru intravilan
-  Accesuri propuse pe amplasament
-  Drumuri de exploatare existente, nemodernizate
-  Drumuri asfaltate
-  Stalpi electricitate

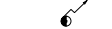
Coordonate contur amplasament
NC 55793, 55794, 59284
59285, 60329, 60332

	EST	NORD
1	613302.8720	601468.0880
2	613304.5480	601473.5670
3	613294.9830	601480.2540
4	613280.3730	601486.7210
5	613270.7740	601486.4620
6	613223.7540	601481.5920
7	613158.7430	601476.0220
8	613275.0630	601756.3220
9	613231.4750	601776.0370
10	613231.4749	601776.0368
11	613228.2200	601777.5090
12	613225.5050	601779.1450
13	613218.4527	601765.1317
14	613186.4970	601701.6340
15	613120.6110	601729.2840
16	613091.0650	601659.7520
17	613010.8860	601704.7260
18	612944.6010	601746.1950
19	612940.4510	601742.3560
20	612712.5710	601531.5520
21	612564.4558	601394.8343
22	612512.2970	601342.1360
23	612424.1320	601253.5120
24	612627.8860	601113.3300
25	612845.5870	600963.5540
26	613212.9274	600710.8263
27	613271.7429	600800.5615
28	613321.5410	600876.4780
29	613256.9290	600921.5560
30	613249.6570	600932.1880
31	613247.7720	600940.4320
32	613246.9970	600949.3490
33	613248.8880	601040.0340
34	613229.7480	601049.8200
35	613230.6190	601074.1455
36	613196.5390	601075.3660
37	613206.3810	601145.9220
38	613207.1820	601151.6610
39	613208.0920	601158.1890
S. total (mp)	499000	

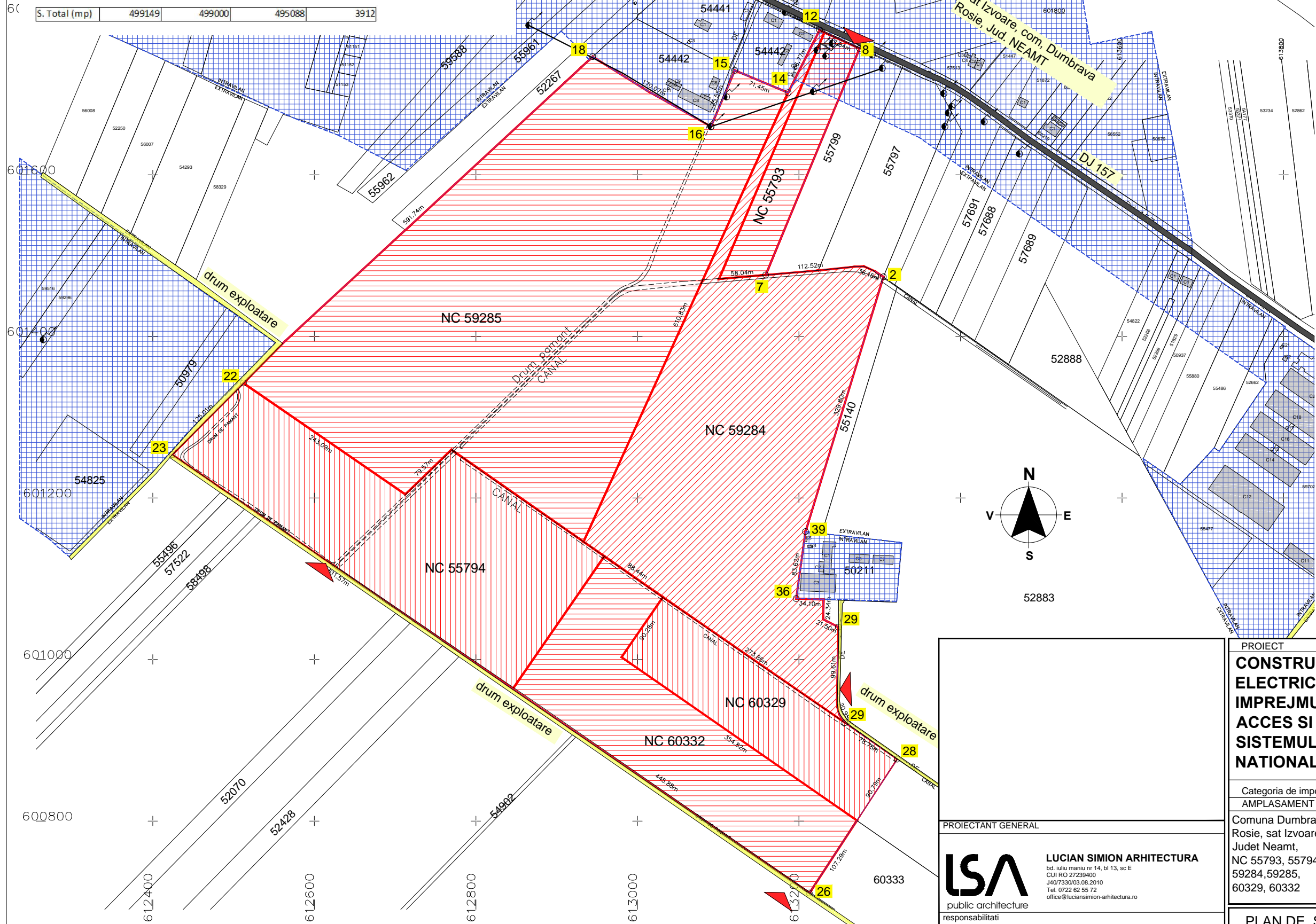

PROIECTANT GENERAL		PROIECT		NR. PROIECT	
LSA public architecture		CONSTRUIRE CENTRALA ELECTRICA DUMBRAVA ROSIE, IMPREJMUIRE TEREN, DRUM ACCES SI RACORDARE LA SISTEMUL ENERGETIC NATIONAL		PV-EC-01/2024	
responsabilitati		Categorie de importanta: C		Clasa de importanta: III	
SEF PROIECT arh. Lucian Simion		AMPLASAMENT		BENEFICIAR	
PROIECTAT arh. Lucian Simion		Comuna Dumbrava Rosie, sat Izvoarele, Judet Neamt,		FAZA	
DESENAT ing. Oana Simion		NC 55793, 55794, 59284, 59285, 60329, 60332		DTAC	
bd. Iuliu Maniu nr. 14, bl. 13, sc. E CUI RO 27239400 J40/7330/03.08.2010 Tel. 0722.62.55.72 office@luciansimion-arhitectura.ro		DUO RENEWABLE ENERGY S.R.L.		Bucuresti, sector 1, Calea Victoriei nr. 155, tronson 6, bloc D1, etaj 8 CUI 47043610; J40/24050/14.12.2023	
PLAN DE SITUATIE					
SCARA DE REDACTARE		DATA INTOCMIRII		ARHITECTURA	
1:5 000		IULIE 2024		NR. PLANSA	
REVIZIA		DATA		U02	